



OSU Conference Services

Oregon State University, 100 LaSells Stewart Center, Corvallis, Oregon 97331-3101
 T 541-737-2402 | F 541-737-9315 | <http://oregonstate.edu/lasells>

Capacity Sheet

Below is a seating capacity chart for the various rooms within LaSells Stewart Center. Please consult the accompanying Building Map for where the various rooms are located within the building.

	Myrtle Tree Alcove (40' x 10') 320 sq. ft.	Agriculture Rooms (3) (36'-9" x 29') 1,260 sq. ft.	Wells Fargo Bank (30' x 26') 794 sq. ft.	Weyerhaeuser (23'-6" x 16') 380 sq. ft.	Const. & Engrg. Hall See Chart Below	Austin Auditorium See Chart Below	Giustina Gallery 3,865 sq. ft.
Ceiling Height	9' 11"	9' 11"	9' 11"	9' 11"	--	--	9' 11"
Seating Capacities							
Theater Style	--	80	49	--	200	1200	--
60" Round Tables	--	56	42	--	--	--	200
Classroom Style	--	60	36	--	--	--	--
Hollow Square Style	--	40	32	--	--	--	--
U-Shaped Style	--	28	28	--	--	--	--
Board Room Style	--	28	24	14	--	--	--
Room Amenities							
Projection Screen (size)	--	8'3"x9'	6'x9'	6'x5'9"	12'6"x13'	30'x23'	--
Dry Erase Board (8'x8')	--	2	2	1	0	0	--
A/V Package	--	YES	YES	YES	YES	YES	--
Adjustable Lighting	YES	YES	--	--	YES	YES	--
Coat Closet	RACKS	YES	--	--	--	--	RACKS
Wireless Internet	YES	YES	YES	YES	YES	YES	YES
Telephone Connection	YES	YES	YES	YES	YES	YES	YES
Food/Drink Allowed	YES	YES	YES	YES	NO	NO	YES

Austin Auditorium	107'-7" x 97'	Construction & Engineering Hall	62'-9" x 48'-8"
	43'-4" Deep		16'-9" Deep
	53'-8" Wide		29' Wide
	26' Ceiling		12' 2" Ceiling
	3"-3" Height		1'-1" Height
Wheel Chair	12	Wheel Chair Spaces	4

LaSells Stewart Center Building Map

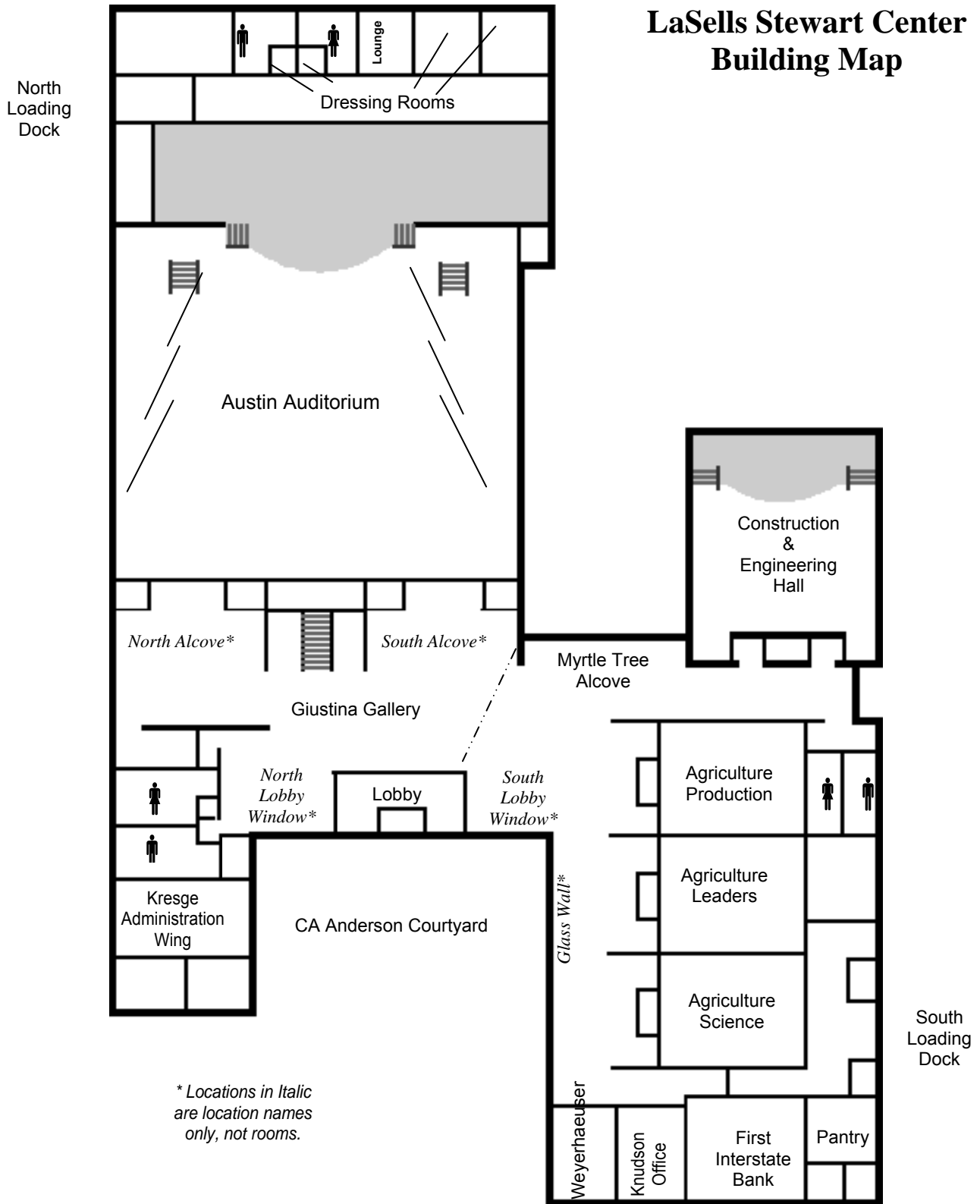

There is a 30 minute loading zone in front of LSC.

Visit our web site at: <http://oregonstate.edu/lasells/>
S:\Email Packet 2009.docx

Driving Instructions To LaSells Stewart Center (LSC)

From I-5 (Portland or Eugene)

From Portland drive south on I-5 or from Eugene drive north on I-5; take Exit 228 (Corvallis/Hwy 34) and turn West. Go West about 10 miles to the second traffic signal. Turn South (left) on the Hwy 34 bypass across the Willamette River. At the next traffic light, the intersection with 15th Street, turn North (right). Proceeded to the intersection of Western Blvd, turn West (left). (See Parking Lot below)

From 99-W (South from McMinnville or Portland)

Drive south on 99-W. In Corvallis, 99-W turns into 4th Street. Follow 4th Street to the traffic light at Western Blvd., and turn West (right). (See Parking Lot below)

From 99-W (Eugene)

Drive north on 99-W. In Corvallis, 99-W turns into 3rd Street. Follow 3rd Street to the traffic light at Western Blvd., and turn West (left). (See Parking Lot below)

Parking Lot: The conference/visitor parking lot is on the northwest corner at the intersection of Western Blvd and 26th Street. This parking lot may be accessed from either Western Blvd or 26th Street. A pay station is located on the south end of the lot. The LaSells Stewart Center is on the northeast corner of the same intersection.

Parking: On-campus lots are available at \$5 per day. Parking pay stations are available in the parking lot adjacent to Reser Stadium. A parking structure is located about 1 block north of LSC and just south of the railroad tracks. Pay stations are located on each floor near the elevators. Shuttle service is available during the school year. We ask that visitors to campus be good neighbors and NOT use the Hilton Garden Inn (HGI) parking lot unless they are staying there.

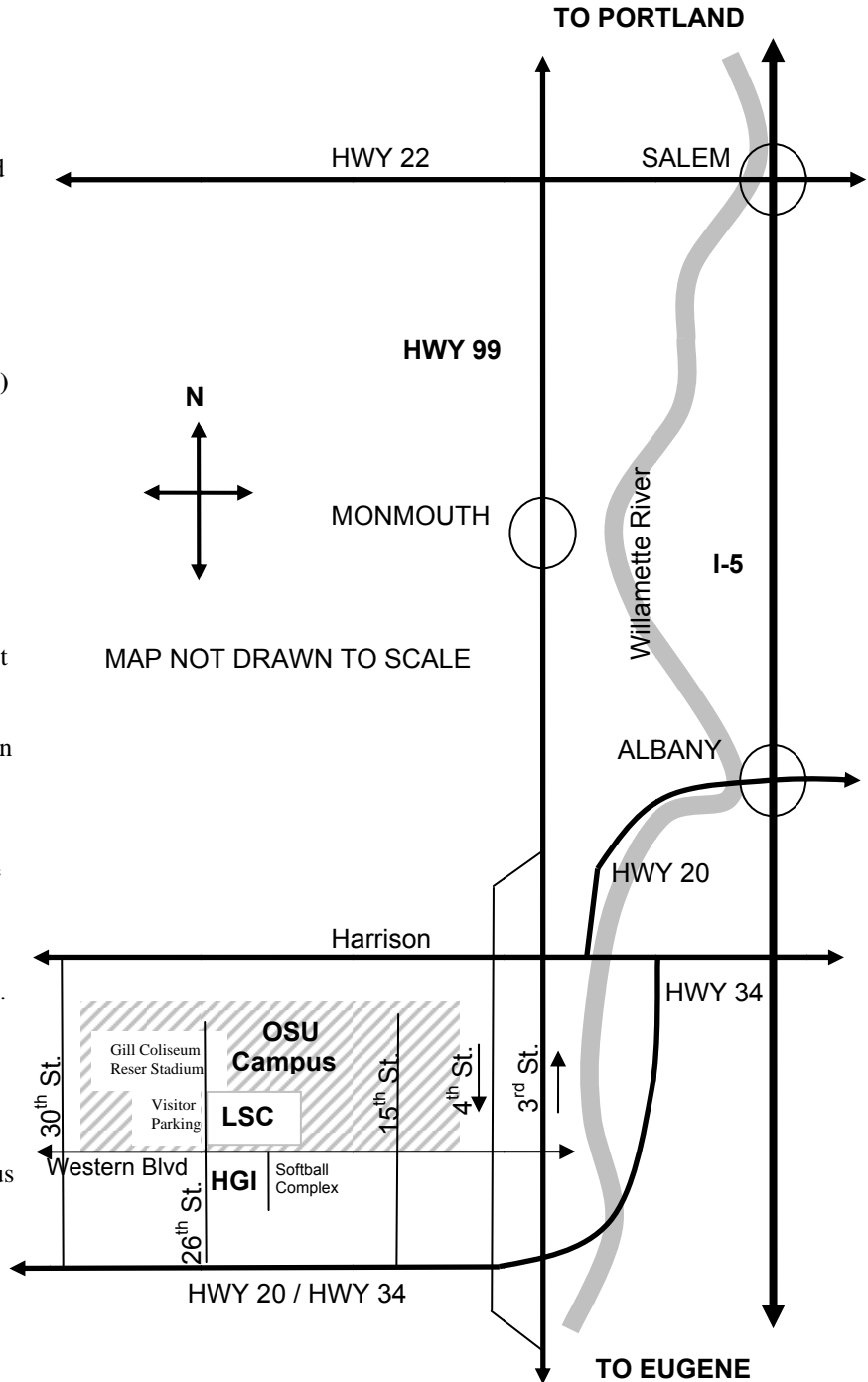

Parking at LaSells Stewart Center

http://oregonstate.edu/facilities/transit_pkg/index_pkg.html

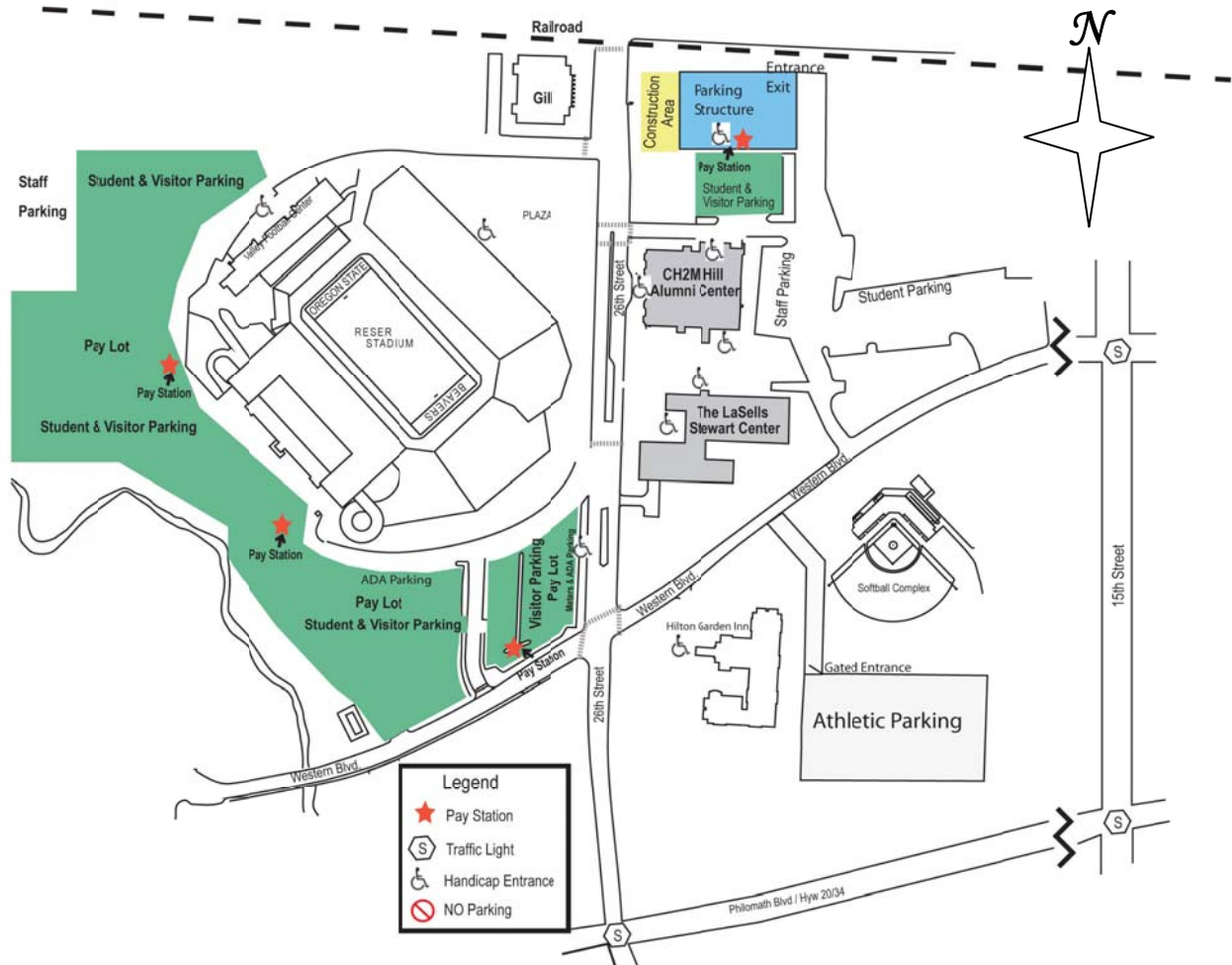

Parking Permits

All parking lots require a parking permit from 7 am to 5 pm Monday through Friday. There are “Pay & Display” stations/kiosks in the Student and Visitor lots adjacent to Reser Stadium and in the Parking Garage to obtain valid permits. The full-day price is \$5, with the parking lot kiosks offering hourly parking passes at \$1 per hour for up to four hours. Visitor Permits for conferences, workshops and meetings may be ordered from the Transit and Parking Services office a minimum of 5 business days prior to the event. Weeklong parking passes are available for \$24. Free Parking in Student & Visitor lots only is available between terms and typically during the first week of class each term - call 541-737-2583 for verification of dates.

Game Day Parking

Parking access may be controlled by the Athletic Department due to a home game. If you are attending an event at LaSells Stewart Center, notify the parking attendant and you should be admitted to the parking area without a parking charge. The exception is home football games, when there is NO FREE parking on campus.



OSU Conference Services

Oregon State University, 100 LaSells Stewart Center, Corvallis, Oregon 97331-3101
T 541-737-2402 | F 541-737-9315 | <http://oregonstate.edu/lasells>

Answers to Parking Questions
at
LaSells Stewart Center & CH2M Hill Alumni Center

Transit & Parking Services

100 Adams Hall, Corvallis OR, 97331-2190
541-737-2583

http://oregonstate.edu/facilities/transit_pkg/index_pkg.html

Where may I park?

- The parking lot across 26th Street from the LaSells Stewart Center, south of Reser Stadium.
- This is a “permit required” lot from 7 AM to 5 PM Monday through Friday.
- The parking lot entrances are off Western Blvd and off 26th Street just south of Reser Stadium.
- Visitor permits may be used in any visitor only or student/visitor lot on the Oregon State University campus (see parking map).

Where do I pay for parking permits?

- There are three “pay and display” stations around Reser Stadium to obtain one-day parking permits. The “pay and display” stations will produce a parking permit that is to be placed on the dash of the vehicle.
- The pay and display stations will accept cash, Visa, MasterCard, or Discover Cards.
- Two-hour coin operated meters are available directly across 26th Street from the LaSells Stewart Center for event attendees and campus visitors.

What do I do with the visitor parking permit?

- The visitor parking permit must be prominently displayed on the dash of the vehicle parked in the lot. The parking permit includes clear instructions.

I bought a permit but I am parked at a meter, is that OK?

- No. A parking permit is for un-metered spaces. If you park at a meter you must pay the meter. You do not need a “pay-and-display” permit to park at a meter.

Is there additional parking if the visitor lot is full?

- The “pay and display” permits are valid in all of the visitor lots and in any student/visitor lot including the student /visitor area of the Reser Parking Lot
- Pay stations are located at several locations around the campus (see parking map).

Is there any free parking?

- Yes. There is free parking in Staff, Student, or Visitor lots on weekends and after business hours (excluding athletic game days).

Where may I NOT park?

- No parking areas are designated with a restricted parking sign. Parking is not allowed in any area that is not designated as a parking space or where normal standard State of Oregon parking restrictions apply (i.e. Yellow/ red stripping, fire hydrants etc.).

I have an OSU Student or Staff permit. Can I park in the parking lot signed “visitor only”?

- No. Only vehicles with “pay and display” permits may park in the Visitor Only parking areas. Students and Staff permits are not valid in the “Visitor Only” areas.

Where is there ADA parking?

- There is ample ADA parking available in the Reser Lot and in the Parking Garage. An OSU (visitor, staff, or student) permit and a valid DMV placard are required during the hours of 7am – 5pm, Monday through Friday. A valid DMV placard is required to use ADA spaces after

hours. A DMV placard also allows you to park free at any 1- or 2- hour coin operated meter.

- The Reser lot visitor pay stations are ADA accessible.

Where can I find a Campus Map?

- Maps are available at the parking website: http://oregonstate.edu/facilities/transit_pkg/index_pkg.html
- Campus maps are available at the LaSells Stewart Center and CH2M HILL Alumni Center.

Where do Buses park?

Please notify the OSU Conference Services or the CH2M HILL Alumni Center if buses will be unloading and loading from 26th Street.

- **The bus lane** on 26th Street directly across from the LaSells Stewart Center is for unloading and loading **only**, not for long-term parking.
- Buses may park in the Reser Stadium lot, Buses do not need a parking pass.
- **If more than one or two buses are expected**, special arrangements can be made to use the lot behind the Hilton for bus parking. The lot is available by special request only.
- **Where can they not park?** In ADA spaces, yellow/red zones or blocking entrances or exits to any parking area or street.
- **If a group is coming with buses (in a Van) do they need parking permits?** Yes.
- **What is the standard operation procedure for Transit And Parking Services to deal with a bus parked in the wrong spot?** Generally the drivers remain with the vehicle and we will ask them to move and direct them to the correct area.

Do government or other campus vehicles need permits?

- **Do vehicles with other campus staff parking permits need to purchase a parking permit?**

OSU honors parking permits from U of O and Cascades Campus.

- **Do government vehicles need to purchase a parking permit?** If government vehicles have “E” plates or “US” plates, they do not need to obtain a permit for a one day event, if longer they will need to purchase the proper permit. They will need to pay the parking meters if parking there.

What do I do if I get a parking ticket?

- **What do LaSells Stewart Center and CH2M HILL Alumni Center’s customers do if they receive a parking ticket?** They will need to contact Transit & Parking Services to pay the fine or appeal the ticket.

Where is there a loading zone?

- On 26th Street there are 30 minute loading areas in front of the LaSells Stewart Center. There are also 15 minute vendor loading areas on the south side of the LaSells Stewart Center and on the north side of CH2M HILL Alumni Center; both areas are accessed from 26th Street.

Parking on Game day

- **Game day parking is generally managed by the Athletic Department. Their contact information is 541-737-7375 or www.osubeavers.com.**
- Parking for your event on game day will be arranged by OSU Conference Services on request.
- When attending an event at LaSells Stewart Center on a game day, it is advisable to confirm with the parking attendant your destination with your tickets, registration form or event flyer.
- No Free Parking on campus for home football games.